

CO-CO DIESEL LOCOMOTIVE 2-RAIL AND 3-RAIL

Nos. 2232 and 2234 2-RAIL — Nos. 3232 and 3234 3-RAIL

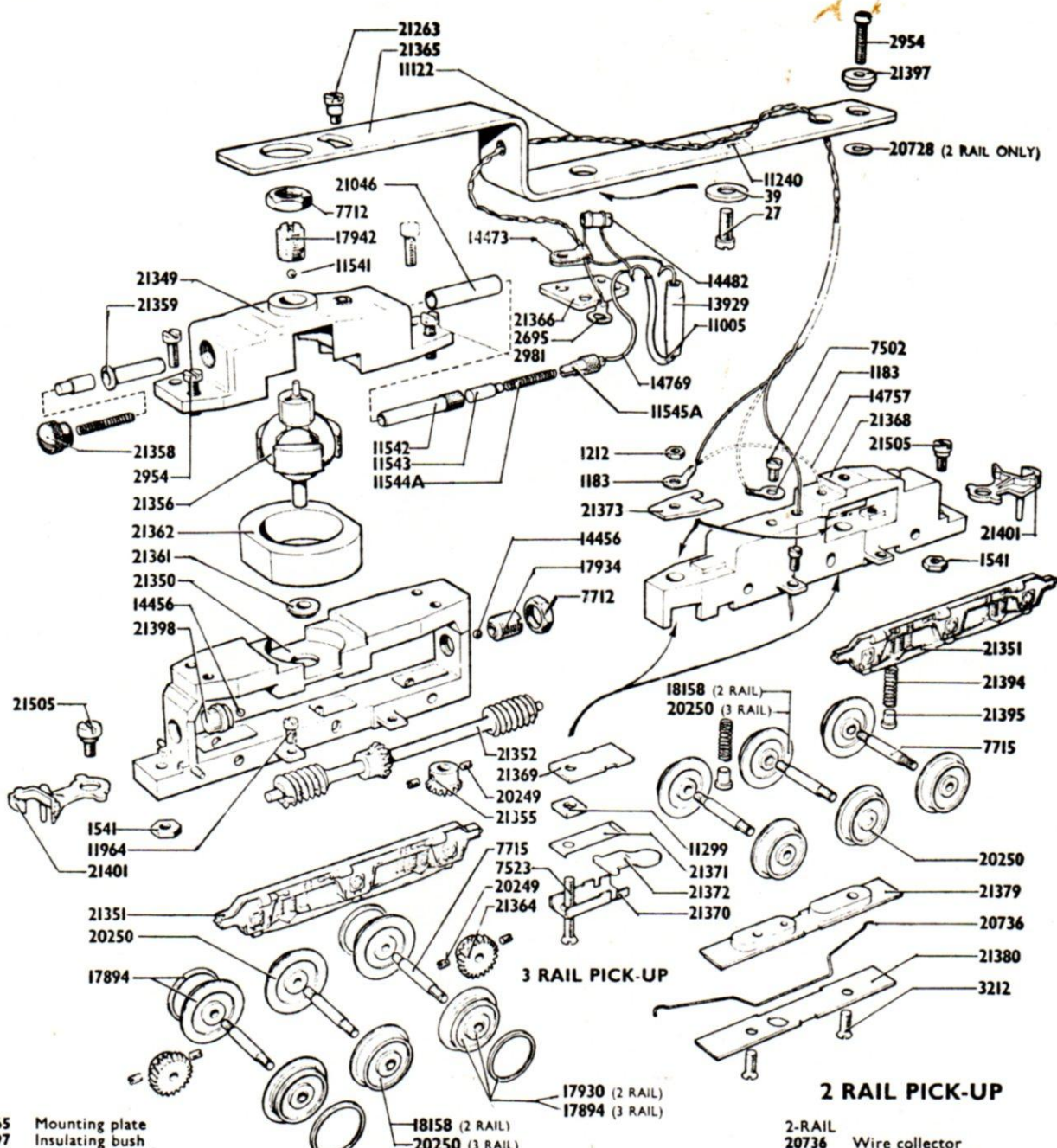

- 21365 Mounting plate
- 21377 Insulating bush
- 27 Screw
- 39 Washer
- 21363 Screw
- 2954 Screw
- 11240 Self-adhesive tape
- 21347 Top casting
- 21350 Bottom casting
- 2731 Screw
- 21351 Sideframe
- 11964 Screw
- 21352 Layshaft assembly
- 21356 Arm. shaft assembly
- 21378 Fixed bearing assembly
- 14456 Ball bearing
- 14458 Adjustable bearing } Adjustable bearing
- 14483 Oil retaining bush } assy.—Job No. 17934
- 21358 Plug
- 21359 Brush holder (with flange)
- 11543 Brush
- 11544A Spring
- 11542 Brush holder
- 21046 Insulating sleeve
- 1541 Nut
- 21361 Bottom bearing
- 21362 Ring magnet
- 21355 Mitre gear
- 20249 Grub screw } Worm wheel assy. } Mitre gear assy.
- 21364 Worm wheel } Job No. 18394 } Job No. 18425

- 20761 Adjustable bearing
- 20768 Oil retaining bearing
- 20769 Lubricating pad
- 11541 Ball bearing
- 7712 Locking nut
- 7715 Axle
- 20250 Wheel
- 20251 Wheel with tyre } Wheel with
- 20252 Tyre } tyre assy.
- 21401 Coupling
- 21505 Screw
- 11545A Plug (with boss)
- 13979 Choke
- 21366 Insulating support
- 11005 P.V.C. sleeve
- 14482 Condenser
- 14473 Clamp for wire
- 14769 Connecting wire
- 2695 Soldering tag
- 11122 Connecting wire
- 21368 Bogie casting
- 7502 Screw
- 1183 Soldering tag
- 21394 Spring
- 21395 Plunger

- 2-RAIL
- 20736 Wire collector
- 21379 Base for collector
- 21380 Cover for collector
- 3212 Screw
- 20702 Wheel (insulated) } Wheel (insulated) assy.
- 20690 Insulating bush } Job No. 18158
- 20703 Wheel (with tyre } Wheel with
- 20252 Tyre } tyre
- 20690 Insulating bush } insulated
- 20728 Washer } Job No. 17930
- 3-RAIL
- 21369 Insulator
- 21370 Collector shoe holder
- 21371 Collector shoe spring
- 21372 Collector shoe
- 21373 Insulator (screw)
- 7523 Screw
- 1212 Nut
- 11299 Distance piece
- 14757 Connecting wire
- BOGIE ASSEMBLIES
- Motor bogie assembly (2-rail)—21348
- Motor bogie assembly (3-rail)—21381
- Rear bogie assembly (2-rail)—21378
- Rear bogie assembly (3-rail)—21367